

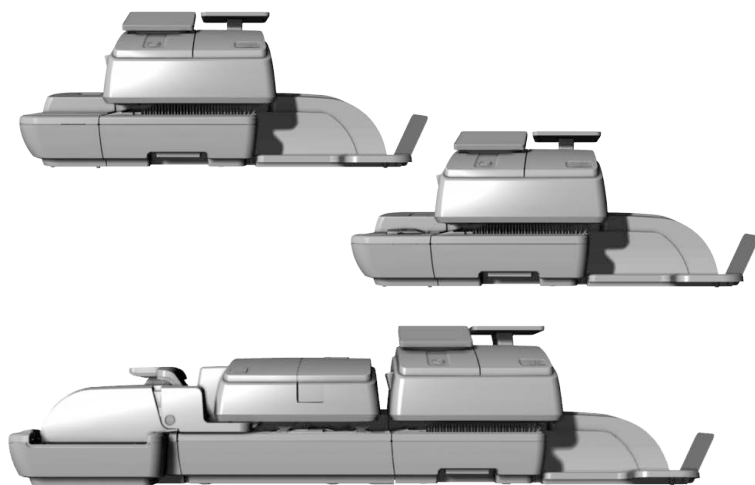

PostBase Fusion

Mailing system



Installation and safety

About this Manual

Please read this manual before installing and using the PostBase Fusion mailing system.

Target audience

This manual is intended for people who set up and install the PostBase Fusion mailing system.

Contents

This manual contains important information for your safety and describes how to set up and install the PostBase Fusion mailing system. Information that only applies to certain configurations and equipment variants is indicated by an addendum, for example *(optional)*.

In this manual, **PostBase Fusion** stands for all models of the PostBase Fusion mailing system.

Further documents

The **Quick Reference Guide** (leaflet) provides an overview of the most important functions for everyday use.

The PostBase Fusion **Reference Guide** contains all the important information on how to use the mailing system. The reference guide is available as a download at Francotyp-Postalia.

The following keywords and signs identify the safety instructions and additional information in this manual:



Warning! indicates a potentially hazardous situation which could result in death or serious injury if disregarded.



Caution! indicates a potentially hazardous situation which could result in minor or moderate injury if disregarded.



Caution! indicates an increased risk or a risky situation which could result in damage to property if disregarded.



A tip offers advice or additional suggestions for improving the operation.

The explanation of the safety signs and product safety labels on the PostBase Fusion mailing system can be found on page 27.

Illustrations

The display illustrations in this manual are examples that may differ from the actual display on your PostBase Fusion. As currency, Euros are used exemplarily.

About this Manual	2
For your safety	4
Installation and commissioning	6
Step 1: Unpacking and checking the contents of the package	6
Step 2: Assembling the PostBase Fusion	9
Step 3: Assembling the hand-feed sealer (<i>optional</i>)	12
Step 4: Connecting the PostBase Fusion	13
Step 5: Turning on the PostBase Fusion	15
Step 6: Installing the PostBase Fusion	15
Step 7: Installing the PostBase Fusion Feeder (<i>optional</i>)	21
Graphical symbols, safety signs and product safety labels on the PostBase Fusion	27
Technical Data	29
Declaration of Conformity	33
License	34
Security Declaration for data usage	36
United States Patents	36
FCC Compliance Statement	37
Service	39

For your safety

The PostBase Fusion complies with the relevant safety regulations for information technology equipment in office environments.

Before setting up and installing and using the PostBase Fusion , please read this safety information and the reference guide carefully.

The reference guide for the PostBase Fusion mailing system is available as a download at Francotyp-Postalia at any time.

For your own safety, please observe the following instructions:

Proper use

- PostBase Fusion is a digital with ink-jet print technology for franking mail.
- The PostBase Fusion is intended only for use in enclosed offices or office-like environments. Observe the operating conditions specified in the 'Technical Data' section.
- The PostBase Fusion is intended exclusively for processing mail pieces in accordance with the specifications described in the 'Technical Data' section.

Prevention of electrical hazards

- Operate the PostBase Fusion only with a grounded single-phase power outlet. Make sure that the power connection conforms to the power requirements indicated on the type plates.
- Make sure the outlets for connecting the PostBase Fusion are close by and easily accessible at all times.
- Unplug the PostBase Fusion power plugs from the outlets in case of an emergency.
- Take care to ensure that no foreign objects penetrate the PostBase Fusion interior.
- Be extremely careful when handling fluids.
- When refilling the sealing fluid, make sure that no live parts become wet.
- Unplug all power plugs of the PostBase Fusion prior to cleaning the .

Prevention of mechanical hazards

- Keep long hair, fingers, loose clothing pieces, neck ties, scarves, jewellery and the like away from moving machine parts.
- Do not remove any parts of the housing.
- Do not remove any equipment related to safety or protection. Do not make them inoperative or unable to function.

Accessories and consumables

- We recommend to use only approved FP equipment and FP original parts. The manufacturer FP has established reliability, safety and applicability. The manufacturer cannot assess the reliability, safety and applicability for products not approved by FP, and therefore not vouch for such products. Full functionality of the PostBase Fusion is only guaranteed at the time of delivery if genuine FP ink cartridges are used.
- Use the supplied power and connection cables or cables that have been approved by FP. Make sure that the cables are not damaged.
- When handling ink cartridges, observe the product information enclosed with each package. Avoid eye and skin contact with the ink. Avoid inhaling ink fumes. Make sure that ink cartridges do not get into the hands of children. Ingestion of the ink can be harmful to health. Detailed information can be found on the Material Safety Data Sheet (MSDS), available at sdb.francotyp.com/en.
- The ink cartridge may be equipped with a clip as transportation protection, depending on the model. Remove the clip before inserting the cartridge. Dispose of the clip. Never put the clip back on the cartridge in order to prevent damage to the print nozzle plate, which can cause short circuits, overheating and melting of components.

General safety instructions

- Set up and install the PostBase Fusion as described in the 'Installation and commissioning' section.
- Never transport the PostBase Fusion by attachments such as weighing platform, label compartment, display or drawer. The best way to transport the individual components is to hold them on the side at the bottom in the recesses on the housing.
- If the was previously in a cold environment (i.e. below 10 °C / 50 °F): Unpack the and wait at least two hours before setup and installation of the PostBase Fusion . The PostBase Fusion needs this time to adapt to the environmental conditions allowing any condensed moisture to escape.
- The 'PostBase Fusion Feeder' is designed for operation on the PostBase Fusion franking machine. The Feeder cannot be operated without being connected to the PostBase Fusion franking machine.
- If the develops strong odours, fumes or unusual noises, immediately unplug the power plugs from the outlets.
- Only have maintenance and repair work carried out by qualified personnel approved by FP. Otherwise any warranty claims may become void.
- Note: When a letter is fed, letter transport will start automatically after a short delay.

Installation and commissioning

This chapter describes how to set up and install the PostBase Fusion in the following versions

- with hand feed tray (basic model)
- with the 'Hand-feed Sealer'
- with the 'PostBase Fusion Feeder'.



Caution! Follow the steps for setup and installation of the PostBase Fusion in precisely the given order to ensure successful installation.

Step 1: Unpacking and checking the contents of the package



- Unpack all the boxes.

Keep the packing. Use it again if you need to transport the or send it in to the Customer Support.

- Check that the contents of the packages are complete and free from any damage.

The scope of delivery is listed on the following pages.



Warning! Damage or the absence of parts can lead to injuries and hazards due to electrical voltage.

Do not start operating the PostBase Fusion if parts are damaged or missing. Please contact FP Customer Support.

*PostBase Fusion franking machine
(1 box)*

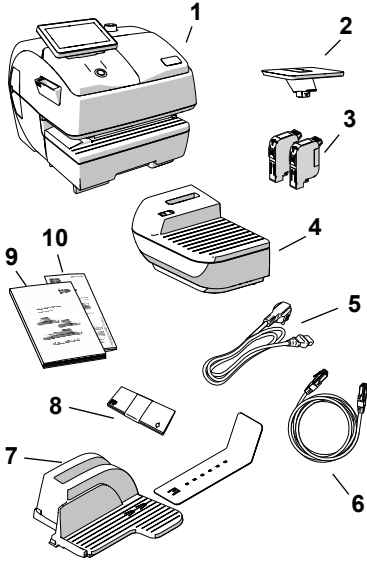

Scope of delivery

Standard configuration:

- 1 PostBase Fusion franking machine
- 2 Weighing platform
- 3 Ink cartridge (*packaged*)
- 4 Hand feed tray
- 5 Power cable
- 6 Ethernet cable
- 7 Catch tray and stop
- 8 Labels
- 9 Installation and safety (brochure)
- 10 Quick Reference Guide (leaflet)

Extra delivery (*by e-mail or postal mail*)

- ☐ R-PIN (Repository-PIN)

Optional, only if ordered separately

*Sealer
(1 box)*

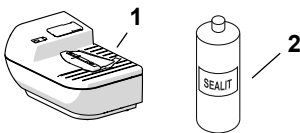

- 1 Hand-feed Sealer
- 2 Bottle of SEALIT (sealing fluid)

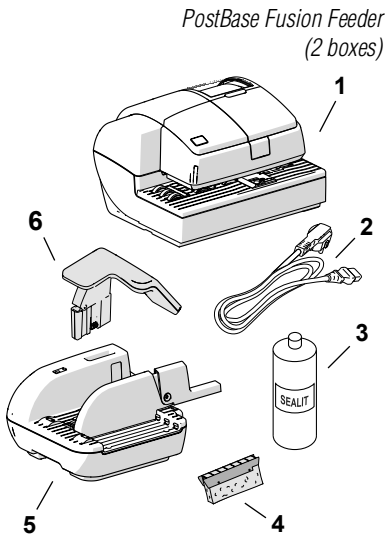

Optional, only if ordered separately

- 1 Feeder (automatic feeder with sealer)
- 2 Power cable
- 3 Bottle of SEALIT (sealing fluid)
- 4 Replacement sponge holder with sponge
- 5 Ramp
- 6 Pendulum

*Drop Stacker
(1 box, not illustrated)*

The delivery package of the Drop Stacker is shown and listed in the installation instructions which come together with the Drop Stacker.

Step 2: Assembling the PostBase Fusion

Installation site

The installation site for the PostBase Fusion must meet the following requirements:

- Firm, level, low vibration and horizontal base, which offers sufficient space for the in the ordered configuration. The dimensions of the individual components can be found at page 29.
- Room temperature in the range from 15 °C to 35 °C / 59 °F to 95 °F.
- No direct sunlight.
- Relative humidity within a range of 15% to 80%, non-condensing.
- Power outlet in the immediate vicinity.
- Network LAN or Wi-Fi connection with internet access.

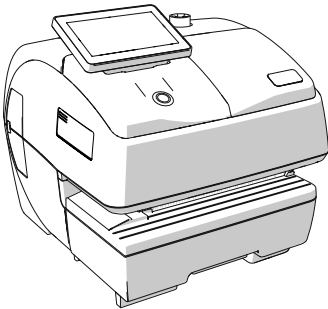

- The PostBase Fusion franking machine must be placed on a suitable surface.
- Remove the protective film from the display.

Assembling the weighing platform

- Hold the weighing platform as shown in the illustration and place it onto the scale receptacle. The long slot in the foot of the weighing platform must slide in the counterpart on the scale receptacle.

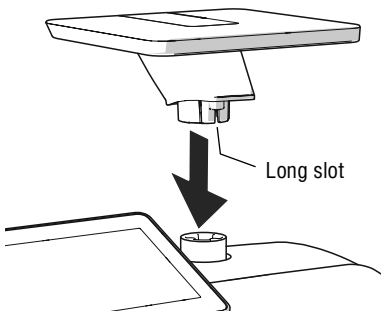

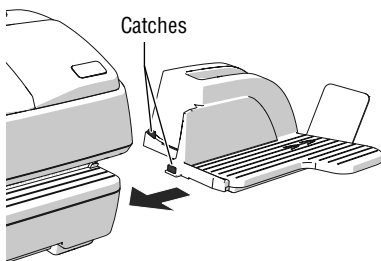
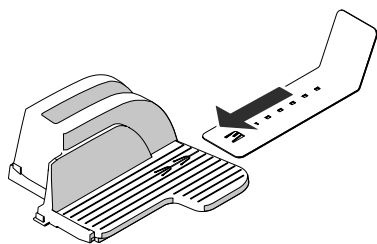

Assembling the catch tray

- Attach the catch bracket to the catch tray:
To do this, insert the catch bracket into the guides on the underside of the catch tray.
- Place the catch tray to the right of the franking machine.
- Slightly lift the franking machine on the right side. The bottom side of the housing features slots where the catch trays are fastened.
- Slide the catch tray under the franking machine so that the catches engage in the slots.
- Carefully place the franking machine on the catch tray.



Assembling the Drop Stacker

Instead of the catch tray, the optional high capacity FP Drop Stacker can be placed to the right of the franking machine. For details on setting up the Drop Stacker, refer to the installation instructions supplied with the Drop Stacker.

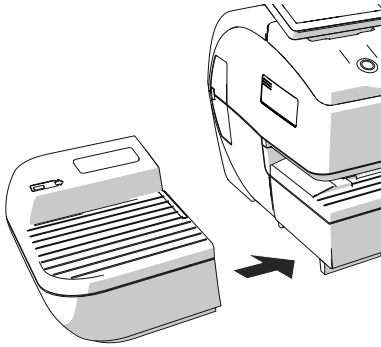
Attaching the hand feed tray*(only on the basic model)*

- Place the hand feed tray for manually feeding the items to the left of the franking machine.
- Slightly lift the franking machine on the left side and push the hand feed tray towards the franking machine so that the front sides are flush.
- Carefully lower the franking machine so that the catches of the hand feed tray engage in the slots on the bottom side of the franking machine.

Step 3: Assembling the hand-feed sealer *(optional)*

The sealer is positioned to the left of the franking machine instead of the hand feed tray. The catches on the right side of the sealer and slots (on the left side of the bottom side of the franking machine) mechanically couple the two components and fasten them in position relative to each other.

Assembling the sealer

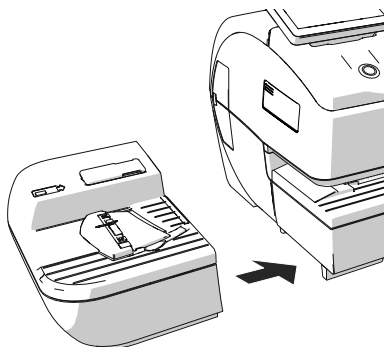

- Place the sealer to the left of the franking machine.
- Gently lift the franking machine on the left side and push the sealer towards the franking machine so that the front sides are flush.
- Carefully lower the franking machine so that the catches of the sealer engage in the slots on the bottom side of the franking machine.

Filling with sealing fluid

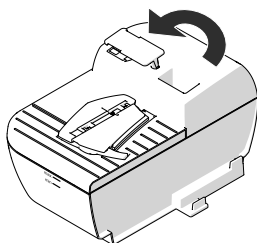

- Swivel the cover of the filling opening to the side.

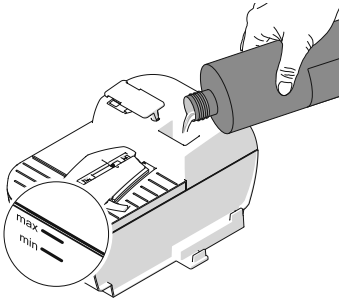

- Fill sealer with SEALIT sealing fluid.
- Check the filling level. The sealer should be filled roughly up to the 'max' mark.

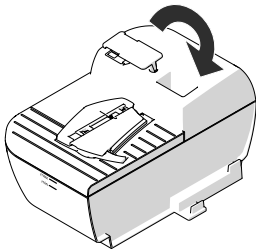

- Close the filling opening with the cover.
- If necessary: Dry the sealer outside.

Note: It may take a few minutes for the fluid to fully prepare the moistening deck and blade.

Step 4: Connecting the PostBase Fusion



Caution! If the PostBase Fusion was previously in a cold environment (i.e. below 10 °C / 50 °F): Wait at least two hours after unpacking before connecting the franking machine. The PostBase Fusion needs this time to adapt to the environmental conditions.



Caution! Do not connect the PostBase Fusion Feeder (the optional automatic feeder) until Step 7. The PostBase Fusion franking machine must be fully installed to do this. Otherwise the Feeder will not be recognised by the franking machine. The will not work.



Warning! Danger from electrical voltage if improperly connected.

- Use the supplied power and connection cables or cables that have been approved by FP. Make sure that the cables are not damaged.
- Only connect the PostBase Fusion to a grounded single-phase power outlet. Make sure that the power connection conforms to the power requirements indicated on the type plate.
- Make sure that the power outlet is nearby and easily accessible at all times.

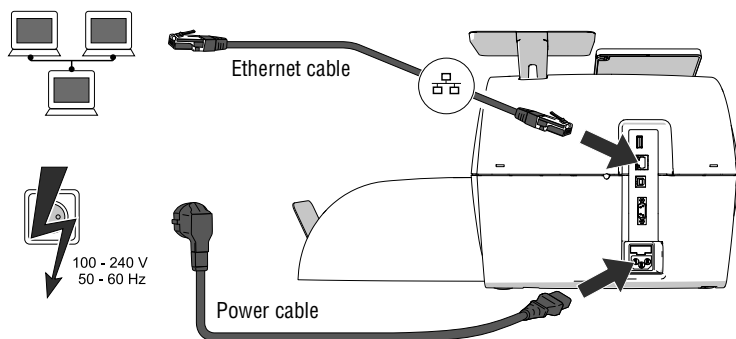

*Connection
Computer Network / Router*

For the wired connection to your local area network (LAN):

- Connect the Ethernet cable to the franking machine and the local network / router.

Power connection

- Plug the power cable into the power connection for the franking machine.
- Only then plug the power cable into the power outlet.

Step 5: Turning on the PostBase Fusion

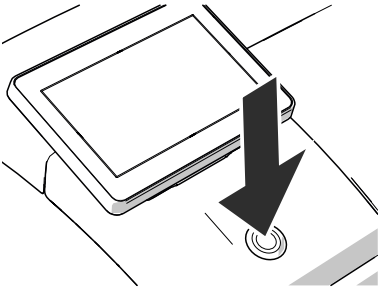

- Press the ON/OFF button.

The LED lighting switches on and the system starts. The progress of the process can be followed on the display. PostBase Fusion greets the user – acoustically accompanied – and finally starts the installation procedure.

Step 6: Installing the PostBase Fusion



The 'swiping' method of operation and other basic functions regarding the touch screen and stylus are described in the reference guide, chapter 'The basics of operation'.

The PostBase Fusion will guide you step-by-step through the installation procedure. Simply follow the instructions on the display.

- Have the R-PIN ready (received separately from the rest of the delivery).

Language

- Tap the desired language.
- Confirm the selection with the CONTINUE button and resume the installation.

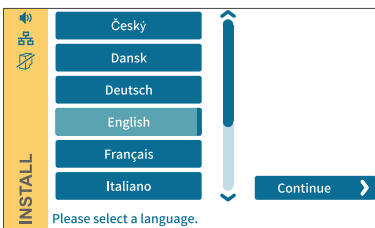

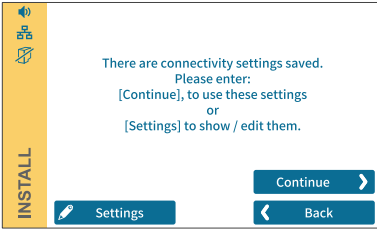

Connectivity settings

Default settings for an Ethernet connection are stored for connecting to the FP infrastructure. Establishing the connection should run seamlessly with these settings.

To test the connection to the FP infrastructure with this default setting:

- Tap the CONTINUE button.

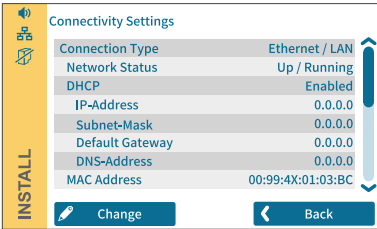

If no connection is established, the 'Connectivity Settings' must be adjusted:

- Tap CHANGE to open the entry wizard for setting up the network connection.

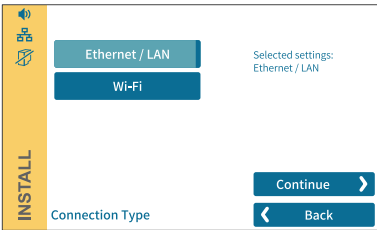

- First select the desired connection type.
- Confirm the selection and continue with the CONTINUE button.
- Set the appropriate parameters for the network step by step. If necessary, ask your network administrator.



The 'Connectivity Settings' overview in the reference guide shows and explains the possible settings.



Caution! During the further course of installation, the PostBase Fusion may start up multiple times. Do not disconnect the PostBase Fusion from the power supply.

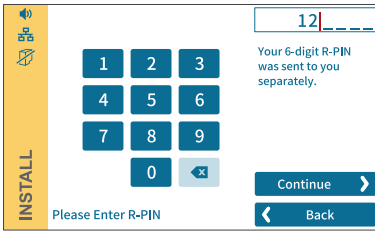

R-PIN

- Enter the R-PIN (Repository-PIN).
- Confirm with CONTINUE and resume the installation.

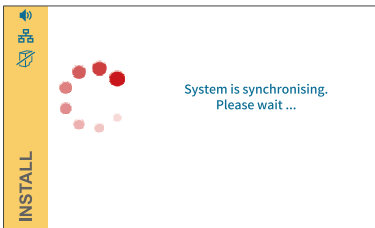

Synchronisation ...

PostBase Fusion now loads software and data and then restarts.

- Follow the information and instructions on the display.



Inserting the ink cartridge

- Tap CONTINUE to insert the ink cartridges.

Note: Do not touch the cover flap of the print system or otherwise obstruct the automatic opening.

PostBase Fusion moves the print system to the change position and then opens the cover flap. The flashing green LED indicates that no cartridge has been inserted yet.

The screen sequence in the display shows the sequence of the cartridge change.

The insertion of the cartridges is described in detail below.

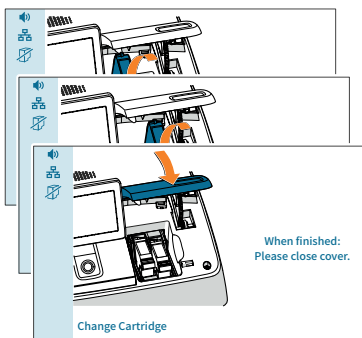



Caution! The ink contains small quantities of harmful substances that can cause irritation to the eyes, skin and respiratory tract and trigger allergic reactions. If swallowed, the ink can be harmful to your health.

- Avoid eye and skin contact with the ink.
- Avoid inhaling ink vapours.
- Avoid swallowing ink.
- Keep the ink cartridge out of reach of children.

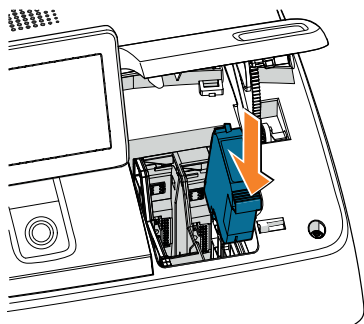

- Take the new ink cartridges out of the packaging.
- Remove the nozzle cover from the ink cartridges.
- See the leaflet enclosed with the ink cartridges for instructions.
- Hold the ink cartridge with the contacts to the rear, i.e. facing the back of the postage meter.
- Insert the ink cartridge into the cartridge holder.
- Push the ink cartridge downwards as far as it will go. The ink cartridge clicks perceptibly into place.

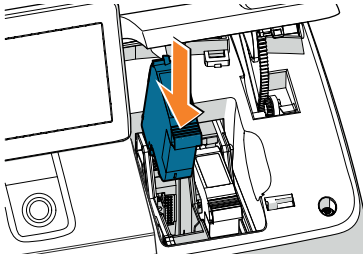

- Repeat these steps to insert the second ink cartridge.

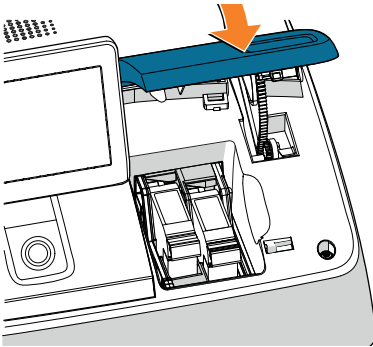

- Close the printing system flap:
Push the flap down at the PostBase Fusion logo until the lock snaps into place.

Be patient: PostBase Fusion will now prepare the cartridges for use.

Calibration

PostBase Fusion calibrates the new ink cartridges after you install them. You can see the process progress on the display. Please wait until calibration is complete.

Cleaning

The ink cartridges are cleaned after calibration. The cleaning process is automatic.

Icon:
Full cartridge

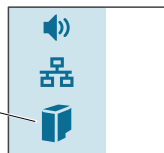

PostBase Fusion displays the 'Full cartridge' icon in the menu bar.

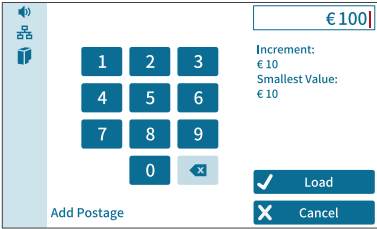

Load Postage

In order to frank, the PostBase Fusion must have available funds. To download postage, this requires a connection to the data centre.

- Follow the instructions on the display.

Home screen (example)



Installation complete

When PostBase Fusion displays the Home screen, the franking machine installation has been successfully completed.

To install the 'PostBase Fusion Feeder', continue with Step 7.



Volume, display inclination and brightness can be adjusted directly on the display frame. The MENU button is used to access other system settings (e.g. PIN protection, standby time).



Visit the customer portal **MyFP**. Your password-protected access will provide you with all the important information about your , extensive administrative functions for cost accounts and user profiles, as well as convenient reporting functions.

Step 7: Installing the PostBase Fusion Feeder (optional)



Caution! Only connect the Feeder once the PostBase Fusion franking machine is fully installed. Otherwise the PostBase Fusion will not recognise the feeder. The will not work.

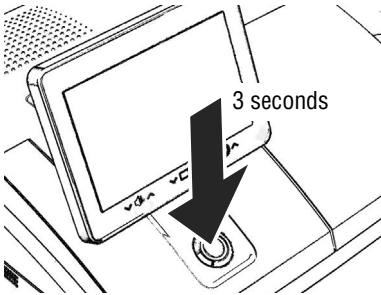

Turning off the franking machine

- Press the ON/OFF button for three seconds.

The PostBase Fusion will complete any current actions, return the display to its home position, and then turn itself off.

Setting up the feeder

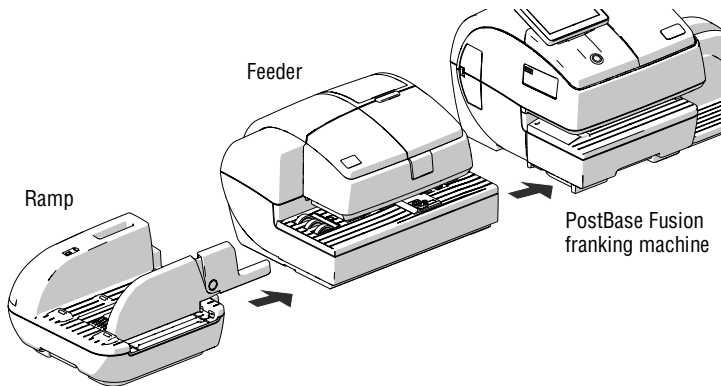

- Place the ramp, feeder and franking machine as shown in the illustration above.
- When assembling, ideally proceed from left to right (starting at the ramp).

The components are mechanically coupled with catches (each on the right housing side) and slots (each on the underside at the left)

and are secured in position relative to each other in this way.

- Lift the feeder slightly, align it to the ramp and lower it carefully. The catches on the ramp must snap into the slots on the Feeder.
- Couple the feeder to the franking machine in the same way.
- Remove the protective film from the transparent cover flap.

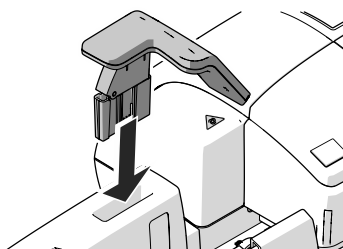

Mounting the pendulum

- Insert the base of the pendulum into the fixture of the ramp.
- Press down firmly on the pendulum until it clicks into the shaft.

Connecting the feeder



Caution! If the feeder was previously in a cold environment (i.e. below 10 °C / 50 °F): Wait at least two hours after unpacking before connecting the feeder. The feeder needs this time to adapt to the environmental conditions.

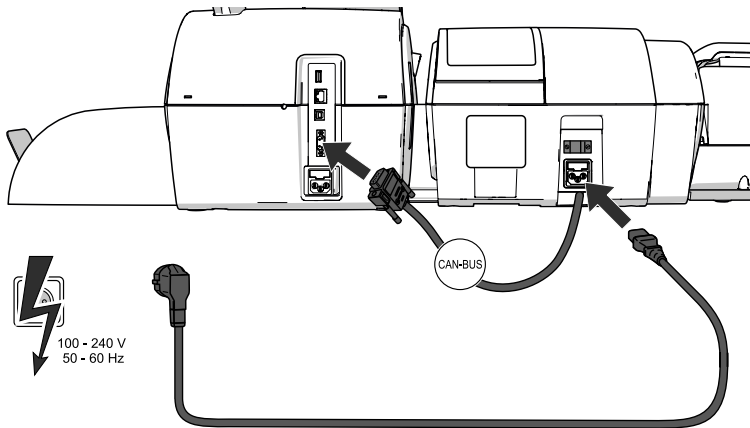

Connection on the franking machine

- Connect the feeder connection cable to the CAN-BUS interface of the franking machine. Screw the connector on tightly.

Power connection

- Plug the power cable into the power connection for the feeder.
- Only then plug the power cable into the power outlet.

Filling the sealant tank with sealing fluid



Warning! Electrical hazard due to short circuits. Be extremely careful when handling fluids. When filling the tank, make sure that no live parts become wet. However, if this does occur: Immediately disconnect the power plug. Have the PostBase Fusion checked by the Customer Support before using it again.

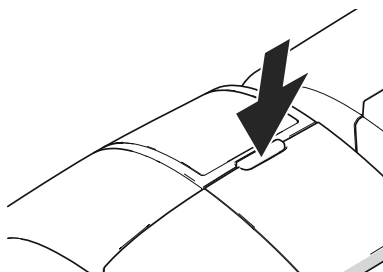

The sealant tank is located under the transparent flap. To open the flap:

- Press the key.

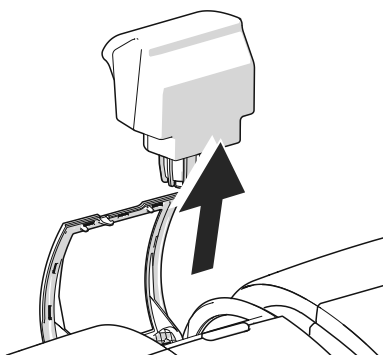

- Remove the sealant tank from the housing.

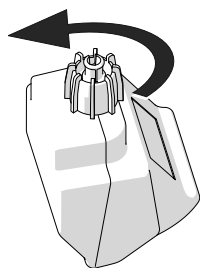

- Unscrew sealant tank screw cover.

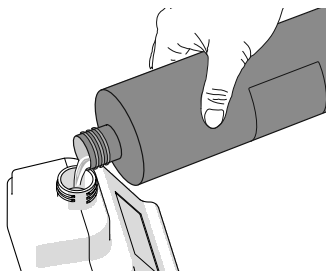

- Fill the sealant tank with SEALIT sealing fluid.

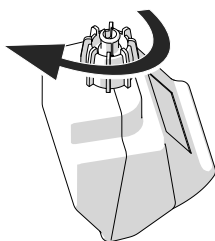

- Replace sealant tank screw cover and tighten.
- Turn sealant tank upside down in a non-dangerous area (e.g. over a sink) to check if the cover is well sealed.

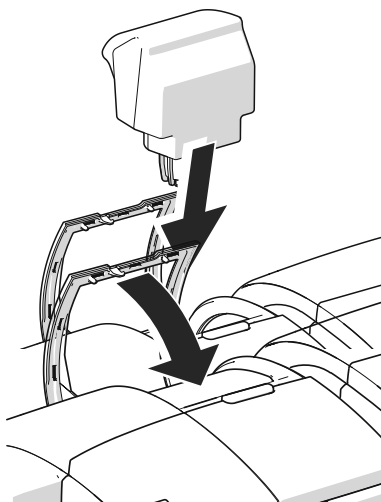

- Insert sealant tank into the feeder with the cover downward.

- Close the flap.

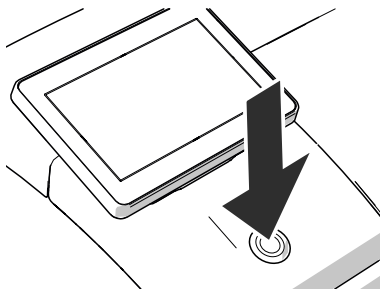

Turning on the

- Press the ON/OFF button.

The LED lighting on the franking machine lights up and the system starts up. You can follow the running startup procedure in the display.

Upon system startup, PostBase Fusion activates the connected system components – the LED status indicator (sealing function ON/OFF) on the feeder starts to light up.



After the system has started up successfully, the Home screen with the additional FEEDER button appears on the display.

The PostBase Fusion with feeder is ready for operation.

Graphical symbols, safety signs and product safety labels on the PostBase Fusion

Graphical symbols, safety signs and product safety labels are affixed to the PostBase Fusion. You will find the product safety labels on the type plates of the individual components.

The following overview lists and explains them.



Warning: Automatic machine operation.

Indicates an automatic machine operation that may result in the user being startled.



GS Mark. 'Geprüfte Sicherheit' (Tested safety) according to the requirements of the German Product Safety Act (ProdSG). Tested by the accredited laboratory NEMKO.



CE label.

With this label, the manufacturer declares that the product meets the requirements of all relevant EU directives that require such labelling.

The manufacturer's EU declaration of conformity for the PostBase Fusion is printed on page 33.



UKCA marking (UK Conformity Assessed).

With this marking, the manufacturer declares the conformity of the product with the corresponding regulations of the United Kingdom. The UKCA marking is comparable to the CE label applicable to the European Economic Area.



Nemko certification mark.

The approval mark indicates that the product complies with the applicable standards as required in the USA and Canada.

Nemko-CCL is a NRTL (nationally registered testing lab), which is entitled to perform this test. Product tested in accordance with IEC 62368-1.



The crossed garbage can is a mark for electrical and electronic equipment (WEEE directive) and means the following:

The product and accessories (e.g. cables and ink cartridges) may not be disposed of with household waste.

The bar below the garbage can indicates that the product was marketed after 13 August 2005.

For proper disposal and recycling of the PostBase Fusion, please contact the FP Customer Service.



Interface for connection to a personal computer (PC).



USB port.

Interface for connection to external USB devices.



Interface for connection to a local computer network (LAN).

CAN-BUS The CAN bus (CAN = Controller Area Network) is a serial bus system. Interface for connecting the feeder.



Symbol for alternating voltage.

Indicates the type of the input voltage.

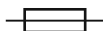

Symbol / Wiring symbol for a fuse.

This symbol always stays along with the details of the fuse used.

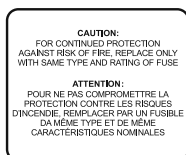

The plate contains important information for the fuse:

Caution: For continued protection against risk of fire, replace only with same type and rating of fuse.

Technical Data

Dimensions *

– Length	310 mm (12.2") – <i>housing</i>
	146 mm (5.7") – <i>hand feed tray / sealer</i>
	385 mm (15.2") – <i>feeder</i>
	280 mm (11") – <i>ramp</i>
	320 mm / 445 mm (12.6" / 17.5") – <i>catch tray min / max</i>
– Width	345 mm / 430 mm (13.6" / 17") – <i>drop stacker min / max,</i> <i>dimensions from the table edge incl. handle</i>
	345 mm (13.6")
– Height	390 mm (15.4") – <i>with ramp</i>
	287 mm (11.3") – <i>with weighing platform</i>
	327 mm (12.9") – <i>highest display position</i>

Weight *

9.4 kg (20.7 lb) – <i>franking machine with scale</i>
0.6 kg (1.3 lb) – <i>hand feed tray</i>
0.6 kg (1.3 lb) – <i>sealer</i>
7.8 kg (17.2 lb) – <i>feeder</i>
2.6 kg (5.7 lb) – <i>ramp</i>
1.0 kg (2.2 lb) – <i>catch tray</i>
5.6 kg (12.4 lb) – <i>drop stacker</i>

Power connection

– Franking machine	100 - 240 V / 1.5 A / 50 - 60 Hz
– Feeder	100 - 240 V / 1.5 A / 50 - 60 Hz

Power consumption

– Franking machine	65 W, Energy Star
	< 0.3 W (switched off)
	< 7 W (standby)
– Feeder	80 W

Display

TFT, 5", 800 × 480 pixels, backlit
Touch panel (resistive)

* Values without packaging

Print system

- **Print technology** Ink-jet, 1 ink cartridge
- **Printing area** max. 185 mm × 25 mm (7.3" × 1")
- **Print resolution** ≥ 300 dpi

Weighing range Depending on machine configuration:
3 g to 7000 g (0.1 oz to 15 lb)

Noise emission < 60 dB(A) franking machine (stand-alone)
< 70 dB(A) franking machine with feeder

Type of Equipment Stand-alone equipment (Desk-top)

Class of Equipment Class I

Connection to Supply Pluggable type A

Type of Power System TN, IT

Mobility Moveable equipment

Pollution Degree 2

Operating conditions +15 °C to +35 °C (59 °F to 95 °F)
Only use in closed rooms
Do not expose to direct sunlight
Rel. humidity 15% to 80%, non-condensing

Performance Depending on system configuration:
up to 120 letters/min
(Varies depending on envelope size / content, imprint length, machine state and operating mode.)

Subject to short-term modification.

Ink cartridge

Ink cartridge	FP ink cartridge for PostBase Fusion
Operating and storage conditions	+15 °C to +35 °C (59 °F to 95 °F) Use in closed rooms only Do not expose to direct sunlight Relative humidity 20% to 70%, non-condensing



Material Safety Data Sheet (MSDS) for users available at
sdb.francotyp.com/en.

Mail piece specifications

Format (height × width)	<u>PostBase Fusion (franking machine with hand feed tray):</u> 89 mm × 127 mm up to 253 mm × 353 mm (3.5" × 5" up to 10" × 14") <u>PostBase Fusion with feeder:</u> 100 mm × 148 mm up to 253 mm × 353 mm (4" × 6" up to 10" × 14")
Thickness	<u>Franking without usage of the sealing function:</u> Up to 10 mm (0.4") <u>Using the sealing function (PostBase Fusion Feeder):</u> Up to 7 mm (0.3")
Material	Ink-absorbent material (suitable for ink-jet printing) No dark paper No glossy coating on the surface to print No bubble-foil material No corrugated board No extremely fibrous paper on which the data matrix could smear
Labels	Self-adhesive labels for PostBase Fusion

Subject to short-term modification.

Envelope specifications for automatic sealing
(PostBase Fusion Feeder)

- Material

Envelopes must be suitable for sealing by machine.
The flap must be at the envelope's long side.
- Sealing area

Sufficient closure can only achieved with continuous sealing area.

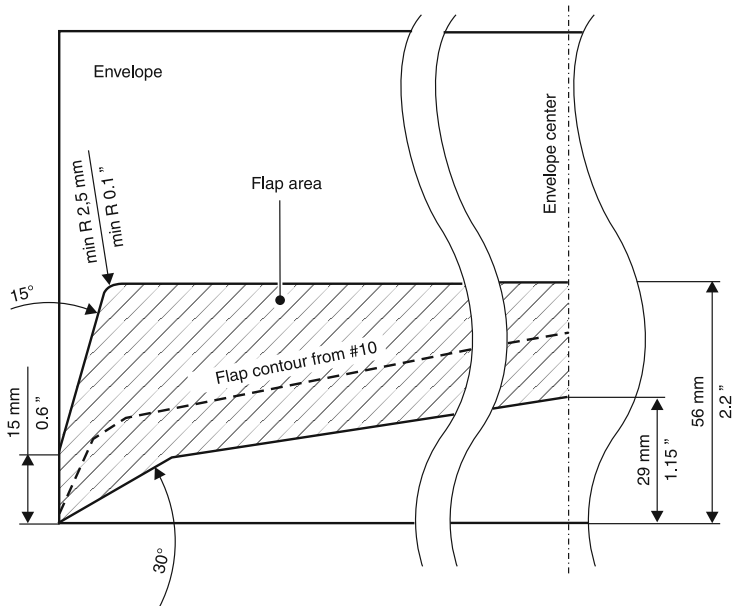

Subject to short-term modification.

EU DECLARATION OF CONFORMITY FOR ELECTRICAL PRODUCTS

Manufacturer: Francotyp-Postalia GmbH

Address: Prenzlauer Promenade 28, 13089 Berlin, Germany

Herewith we declare under our sole responsibility that the franking system consisting of:

**PostBase / PostBase Vision,
PostBase Feeder / PostBase Feeder plus,
PostBase Dynamic Scale**

.....

which this declaration refers to, is in accordance with the conditions of the Low Voltage Directive 2014/35/EU and the EMC Directive 2014/30/EU.

The franking system and its components are in conformity with following harmonized standards:

EN 60950-1: 2006 + A2: 2013
EN 55022: 12.2010, Class B
EN 55024: 11.2010
EN 61000-3-2: 2014
EN 61000-3-3: 2013

Additionally, the model **PostBase Vision** conforms to the essential requirements of the Radio Equipment Directive (RED) 2014/53/EU. Harmonized standards listed below have been used to demonstrate the conformity:

EN 62311:2008	(Art. 3.1a Health & Safety)
EN 301 489-1 V2.2.2 [Draft]	(Art. 3.1b EMC)
EN 301 489-17 V3.2.0 [Draft]	(Art. 3.1b EMC)
EN 300 328 V2.1.1	(Art. 3.2 Spectrum)

We also declare that the products identified above are compliant to the RoHS Directive (2011/65/EU).

January 2019

.....

Sven Meise
Managing Director

.....

Uwe Hübler
Head of R&D

(Legally binding signatures for the company)

License

This is a copy of the current LICENSE file inside the CVS repository.

```
LICENSE ISSUES
=====
```

The OpenSSL toolkit stays under a dual license, i.e. both the conditions of the OpenSSL License and the original SSLeay license apply to the toolkit. See below for the actual license texts. Actually both licenses are BSD-style Open Source licenses. In case of any license issues related to OpenSSL please contact openssl-core@openssl.org.

```
OpenSSL License
-----
```

```
/* =====
 * Copyright (c) 1998-2011 The OpenSSL Project. All rights reserved.
 *
 * Redistribution and use in source and binary forms, with or without
 * modification, are permitted provided that the following conditions
 * are met:
 *
 * 1. Redistributions of source code must retain the above copyright
 * notice, this list of conditions and the following disclaimer.
 *
 * 2. Redistributions in binary form must reproduce the above copyright
 * notice, this list of conditions and the following disclaimer in
 * the documentation and/or other materials provided with the
 * distribution.
 *
 * 3. All advertising materials mentioning features or use of this
 * software must display the following acknowledgment:
 * "This product includes software developed by the OpenSSL Project
 * for use in the OpenSSL Toolkit. (http://www.openssl.org/)"
 *
 * 4. The names "OpenSSL Toolkit" and "OpenSSL Project" must not be used to
 * endorse or promote products derived from this software without
 * prior written permission. For written permission, please contact
 * openssl-core@openssl.org.
 *
 * 5. Products derived from this software may not be called "OpenSSL"
 * nor may "OpenSSL" appear in their names without prior written
 * permission of the OpenSSL Project.
 *
 * 6. Redistributions of any form whatsoever must retain the following
 * acknowledgment:
 * "This product includes software developed by the OpenSSL Project
 * for use in the OpenSSL Toolkit (http://www.openssl.org/)"
 *
 * THIS SOFTWARE IS PROVIDED BY THE OpenSSL PROJECT ``AS IS'' AND ANY
 * EXPRESSED OR IMPLIED WARRANTIES, INCLUDING, BUT NOT LIMITED TO, THE
 * IMPLIED WARRANTIES OF MERCHANTABILITY AND FITNESS FOR A PARTICULAR
 * PURPOSE ARE DISCLAIMED. IN NO EVENT SHALL THE OpenSSL PROJECT OR
 * ITS CONTRIBUTORS BE LIABLE FOR ANY DIRECT, INDIRECT, INCIDENTAL,
 * SPECIAL, EXEMPLARY, OR CONSEQUENTIAL DAMAGES (INCLUDING, BUT
 * NOT LIMITED TO, PROCUREMENT OF SUBSTITUTE GOODS OR SERVICES;
 * LOSS OF USE, DATA, OR PROFITS; OR BUSINESS INTERRUPTION)
 * HOWEVER CAUSED AND ON ANY THEORY OF LIABILITY, WHETHER IN CONTRACT,
 * STRICT LIABILITY, OR TORT (INCLUDING NEGLIGENCE OR OTHERWISE)
 * ARISING IN ANY WAY OUT OF THE USE OF THIS SOFTWARE, EVEN IF ADVISED
 * OF THE POSSIBILITY OF SUCH DAMAGE.
 * =====
 *
```

```
* This product includes cryptographic software written by Eric Young
* (eay@cryptsoft.com). This product includes software written by Tim
* Hudson (tjh@cryptsoft.com).
*
*/
```

```
Original SSLeay License
-----
```

```
/* Copyright (C) 1995-1998 Eric Young (eay@cryptsoft.com)
* All rights reserved.
*
* This package is an SSL implementation written
* by Eric Young (eay@cryptsoft.com).
* The implementation was written so as to conform with Netscapes SSL.
*
* This library is free for commercial and non-commercial use as long as
* the following conditions are aheared to. The following conditions
* apply to all code found in this distribution, be it the RC4, RSA,
* lhash, DES, etc., code; not just the SSL code. The SSL documentation
* included with this distribution is covered by the same copyright terms
* except that the holder is Tim Hudson (tjh@cryptsoft.com).
*
* Copyright remains Eric Young's, and as such any Copyright notices in
* the code are not to be removed.
* If this package is used in a product, Eric Young should be given attribution
* as the author of the parts of the library used.
* This can be in the form of a textual message at program startup or
* in documentation (online or textual) provided with the package.
*
* Redistribution and use in source and binary forms, with or without
* modification, are permitted provided that the following conditions
* are met:
* 1. Redistributions of source code must retain the copyright
* notice, this list of conditions and the following disclaimer.
* 2. Redistributions in binary form must reproduce the above copyright
* notice, this list of conditions and the following disclaimer in the
* documentation and/or other materials provided with the distribution.
* 3. All advertising materials mentioning features or use of this software
* must display the following acknowledgement:
* "This product includes cryptographic software written by
* Eric Young (eay@cryptsoft.com)"
* The word 'cryptographic' can be left out if the rouines from the library
* being used are not cryptographic related :-).
* 4. If you include any Windows specific code (or a derivative thereof) from
* the apps directory (application code) you must include an acknowledgement:
* "This product includes software written by Tim Hudson (tjh@cryptsoft.com)"
*
* THIS SOFTWARE IS PROVIDED BY ERIC YOUNG ``AS IS'' AND
* ANY EXPRESS OR IMPLIED WARRANTIES, INCLUDING, BUT NOT LIMITED TO, THE
* IMPLIED WARRANTIES OF MERCHANTABILITY AND FITNESS FOR A PARTICULAR PURPOSE
* ARE DISCLAIMED. IN NO EVENT SHALL THE AUTHOR OR CONTRIBUTORS BE LIABLE
* FOR ANY DIRECT, INDIRECT, INCIDENTAL, SPECIAL, EXEMPLARY, OR CONSEQUENTIAL
* DAMAGES (INCLUDING, BUT NOT LIMITED TO, PROCUREMENT OF SUBSTITUTE GOODS
* OR SERVICES; LOSS OF USE, DATA, OR PROFITS; OR BUSINESS INTERRUPTION)
* HOWEVER CAUSED AND ON ANY THEORY OF LIABILITY, WHETHER IN CONTRACT, STRICT
* LIABILITY, OR TORT (INCLUDING NEGLIGENCE OR OTHERWISE) ARISING IN ANY WAY
* OUT OF THE USE OF THIS SOFTWARE, EVEN IF ADVISED OF THE POSSIBILITY OF
* SUCH DAMAGE.
*
* The licence and distribution terms for any publically available version or
* derivative of this code cannot be changed. i.e. this code cannot simply be
* copied and put under another distribution licence
* [including the GNU Public Licence.]
*/
```

Security Declaration for data usage

Product Description: PostBase Fusion

The PostBase Fusion is connected to the user's local network through an Ethernet interface / Wi-Fi to share data with the FP Data Centre using both the local network and a suitable available internet connection provided by the user.

Francotyp-Postalia guarantees that the PostBase Fusion does not utilise, transmit, or sort any data from the user's network which is not relevant for the operation of this equipment.

United States Patents

Following patents and applications for patents, designs and trademarks are reserved for the mailing machine PostBase Fusion.

U.S. Patent Numbers:

6,733,194 6,739,245 6,953,234 7,346,743 7,437,756 7,606,264 7,694,010
7,793,000 7,996,884 8,091,979 8,131,959 8,136,813 8,262,178 8,405,693
8,562,097 8,567,779 8,668,329 8,682,801 8,702,229 8,926,089 8,933,591
9,102,140 10,011,452 10,150,636 10,502,613 10,538,083 10,562,298 10,579,095
10,690,535 11,334,050 11,482,053 11,630,897

U.S. Design Numbers:

689,130; 689,131; 689,132; 689,133

U.S. Trademark Numbers:

4,589,089 (PostBase); 4,779,760 (FP - Logo)

Status as of 11/22/2023.

An update is published on our patent-website: www.fp-usa.com/patents

FCC Compliance Statement

This device complies with FCC Part 15, Subpart B, Class B.

Note: This equipment has been tested and found to comply with the limits for a Class B digital device, pursuant to part 15 of the FCC Rules. These limits are designed to provide reasonable protection against harmful interference in a residential installation. This equipment generates, uses and can radiate radio frequency energy and, if not installed and used in accordance with the instructions, may cause harmful interference to radio communications. However, there is no guarantee that interference will not occur in a particular installation. If this equipment does cause harmful interference to radio or television reception, which can be determined by turning the equipment off and on, the user is encouraged to try to correct the interference by one or more of the following measures:

- Reorient or relocate the receiving antenna.
- Increase the separation between the equipment and receiver.
- Connect the equipment into an outlet on a circuit different from that to which the receiver is connected.
- Consult the dealer or an experienced radio/TV technician for help.

Contains Transmitter Module FCC-ID: Z64-WL1835MOD

Service Every PostBase Fusion mailing system is thoroughly checked before leaving the factory. Should any faults occur with your PostBase Fusion mailing system in spite of our extensive quality control, please contact FP help line.

